

INSTRUCTION MANUAL

WARE WASHING REF : D-LV50-A3P



To ensure proper use of this appliance and your safety, please read the following instructions completely before operating this appliance.

English – Original



Index

SAFETY & WARRANTY	3
Inspection upon receipt	3
Safety	3
TECHNICAL SPECIFICATIONS	4
INSTALLATION	5
Preliminary checks	5
Connection with water supply	5
Connection with the drainage	5
Connection with the power supply	5
OPERATION	6
Preparation	6
Control Panel	6
Starting the machine	6
Procedures before washing	6
Standby	7
Thermo-Protector	7
Washing Cycle Selection - Start	7
Draining	7
Filling of Detergent and Rinse Aid	7
Cold Water Rinse	8
Shutting down the machine	8
ECO Function	8
Soft Start Function	8
User's Menu	9
Maintenance and Repair	9
Alarm Indications	9
TROUBLESHOOTING	10
ELECTRICAL DIAGRAM	11
EXPLODED VIEW AND SPARE PARTS LIST	12
STANDARDS AND DIRECTIVES	15
PACKAGING AND DEVICE DISPOSAL	15



SAFETY & WARRANTY

INSPECTION UPON RECEIPT

Upon arrival of the package check if there is any visible damage or indications of rough handling that may be caused during transportation. In case that you spot any damages or you have doubts that the package was abused during transportation, please abort the installation and contact your supplier as soon as possible. Every washing machine before departure from our premises is tested in order to ensure its proper function and it is accompanied by the corresponding test report.

SAFETY

This machine should be used only for the purpose that is intended, according to the operation instructions described herein. It is not allowed to modify it in any way. In case that this machine is either used not in compliance with the operation instructions or after technical modifications, the manufacturer is not responsible for its good operation or possible accidents.

CAUTION: THE WASHING WATER IS NOT POTABLE!

Prior to the installation of the machine, please advise the label with its technical specifications (it is mounted on the side of the machine) and check carefully if it is compatible with the power supply network of your area. In any case that there is deviation, please abort the installation procedure.

If the washing machine's door is left accidentally open, a safety switch interrupts the washing procedure. In case of overload or overheating of the pump, there is also a safety switch that interrupts the power supply to the machine. That switch could be activated by the user as soon as the problem is remedied.

The installation of this ware washing machine, as well as its maintenance, should be performed by licensed technician according to the local regulations of your area and the herein described instructions.

Waste disposal

According to the Directive 2002/95/EC OF THE EUROPEAN PARLIAMENT AND OF THE COUNCIL of 27 January 2003 on the restriction of the use of certain hazardous substances in electrical and electronic equipment (AHHE), the products and their parts covered by this directive should not be disposed of with regular garbage but be returned to the point of sale or be transferred to a recycling center for electrical and electronic appliances.

For further information address to the local authorities

TECHNICAL SPECIFICATIONS

Model	D-LV50-A3P
Voltage	230 V 1 ~ N 50/60 Hz - 400 V 1~ N 50/60Hz
Max Power	2,8 Kw / 6,6 Kw
Max Amperes	12,5A / 16,4 A
Boiler heating element	2,5 Kw / 6 Kw
Tank heating element	2,5 Kw
boiler capacity	6 Lt
tank capacity	35 Lt
Ex Dimensions	570 x 600 x 830 mm
basket dimensions	500 X 500 mm
Washing cycles	60 / 120 / 180 sec
Washing pump power	0,75hp
peristaltic detergent pump	Standard
Peristaltic rinse aid pump	Standard
Draining pump	Standard
boiler thermofuse	105oC thermofuse
tank thermofuse	99oC thermofuse
Power cable	without plug
max glass	325
max dish	335
Packing Dimensions	590 x 690 x 1000
Weight	60
Basket for glasses	1
Basket for Dishes	1
Cultery container	1
Tray for plates	0
water inlet hose	1 pcs

INSTALLATION

Preliminary checks

- The installation should be performed by licensed technician according to the instructions of this manual and the legal regulations of your area.
- Be sure that the machine was not damaged during handling.
- Check carefully that the technical details of this ware washing machine (written on the nameplate) are compatible with your network's power supply.
- Prior using the washing machine for first time, clean it thoroughly with a conventional detergent.

Connection with water supply

- Place the washing machine in the desirable place in sufficiently stable horizontal ground.
- Be sure that the power supply is not connected.
- The water inlet and water outlet hoses that are required for the installation are included in the package. Before connection you should rinse them.
- The water inlet hose should have a diameter of at least 16 mm and the connection with the pipe $\frac{3}{4}$ ".
- The minimum water supply pressure should be 2 bar and the maximum 5 bar.
- In the water supply hose there should be installed a non-returning valve according to DIN 1988

Connection with the drainage

- Connect the drainage of the washing machine with your network's drainage as shown in the next figure :

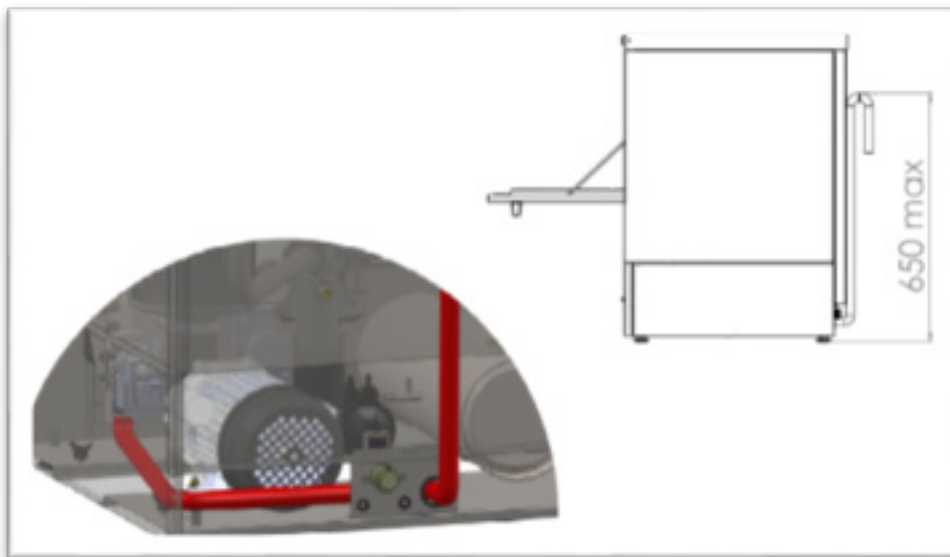

Special care should be given so that the highest point of the flexible drainage hose is placed lower than 650 mm. Otherwise, reverse flow of the water could occur.

Connection with the power supply

This machine works under specific power supply and voltage that are explicitly mentioned in the nameplate of the product. Prior installation please kindly check it.

The installation procedure should be performed by licensed technician.

OPERATION

This washing machine is intended only for cleaning dishes, plates, forks, knives etc. Be careful in order to wash items suitable for dishwashing. Solid food residuals should be removed from the items before washing them in the machine. For better results you could soak the items for some time, especially if there is elapsed enough time after usage. Do not use this machine for washing items that were in service / contact with acids, mineral oil, grease, gasoline or colors.

Preparation

Fill the baskets placing the glasses and cups with the opening facing down in the locations of the basket that have the correct molding. Plates should be stacked vertically in appropriate baskets without touching each other. In any case avoid the overloading of the baskets.

Control Panel

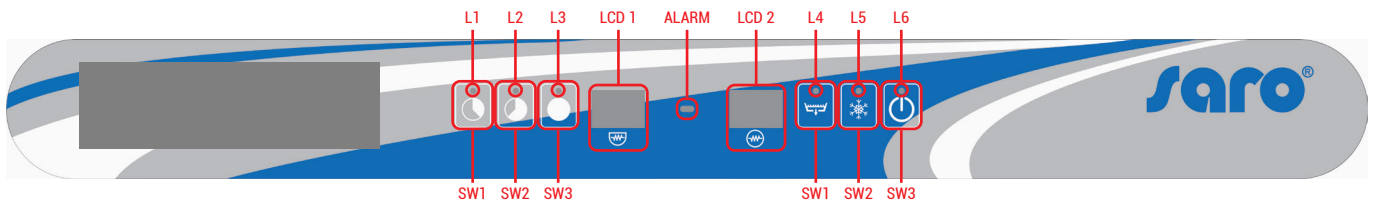



BOUTON	NOM	DESCRIPTION	NOTES
SW1	CT1	Short Cycle Button	Duration 1 min
SW2	CT2	Medium Cycle Button	Duration 2 min
SW3	CT3	Long Cycle Button	Duration 3 min
SW4	DB	Drain Pump Button	
SW5	CRB	Cold Rinse Button	
SW6	ON	ON/OFF Switch	
LED TABLE			COLOR
L1	LED of short cycle selection		
L2	LED of medium cycle selection		
L3	LED of long cycle selection		
L4	Drain in Progress		
L5	Cold Rinse Selected		
L6	LED of ON/OFF Switch		

Starting the machine

In order to start the machine, press the Button SW6 (ON) for 3 sec. The LED L6 flashes red and a buzzer sounds.

Procedures before washing

Since the washing machine is switched on, the boiler and the wash tank start filling with water. Next, the machine gets filled with detergent and rinse aid. During these, a "FILL" message appears on the Dash. After the tanks are filled with water and the necessary detergent and rinse aid liquids are captured, the boiler's heating resistance and the wash tank's heating resistance start working sequentially (after reaching boiler's temperature of operation, its resistance shuts down and the wash tank starts heating). On the LCD1 & LCD2 screens the current temperature of each tank is displayed alternately (when LCD 1 shows "bt" then LCD 2 displays boiler's temperature; when LCD 1 shows "tt", then LCD 2 displays tank temperature). In case that the wash tank's heating resistance is ON, a dot in the right lower corner of LCD1 is lit, while in case that the boiler's heating resistance is ON a dot in the right lower corner of LCD2 is lit. For that reason, symbol  (representing the tank) is shown beneath of LCD1 & symbol  (representing the boiler) is shown beneath of LCD2.

Standby

During Standby operation (after the automatic set up procedures), LCD 1 & LCD 2 should display the temperature of the wash tank & boiler tank alternately.

LCD1	LCD2
bt ou tt (alternating)	--°C

If the machine stays on Standby mode for more than 30 min, then it turns into sleeping mode for minimizing power consumption. When this occurs, LCD 1 & LCD 2 turn off and L6 is flashing. By pushing SW6, the machine is again ready for operation.

Thermo-Protector

In order to start the first washing cycle of the day, both temperatures in the tank and the boiler must reach operational values (60 & 85 respectively). In all the other cycles, due to Thermo-Protector system, if the temperature in the boiler is not appropriate for rinsing, the washing cycle continues until the rinse water becomes sufficiently heated. A message on the screen informs the user that the washing cycle continues; LCD1 shows the current value of the water temperature in the boiler and LCD2 shows "ht" (i.e. heating).

Washing Cycle Selection - Start

This washing machine has three washing cycle program options. The user could choose between short, medium and long program by pushing one of the buttons SW1, SW2 or SW3 accordingly. After pushing the corresponding button, the washing cycle starts automatically, UNLESS the door is accidentally open. In the latter case a message "door" is shown in the Dash and the washing starts again as soon as the door is closed. The remaining time (in seconds) is displayed on the Dash.

⚠ Important note: In case that the door is open accidentally before program is finished, the washing stops and the timer resets. Therefore, in order to finish the cycle, you should start the procedure from the beginning.

⚠ Important note: 10 sec before finishing main wash the draining pump starts working and it stops 10 sec after rinse cycle.

After completion of the washing cycle, a message "end" on the dash informs the user that the program is finished. The message appears until the door is opened again.

Draining

This machine has draining pump, so that the draining cycle is performed automatically. If you want to perform draining on demand, please remove the overflow hose that is placed on the wash tank and press the Button SW4. After 15 sec the draining starts and LED L4 flashes.

During draining, an internal check of the system is performed, ensuring that the heating resistances are switched off. In that sense, any possible overheating caused by heating resistances not immersed in water is avoided. As soon as draining stops, for the next 30 sec the system performs self-cleaning (door must be closed).

⚠ Kindly note that after every On-Demand draining execution, the machine shuts down.

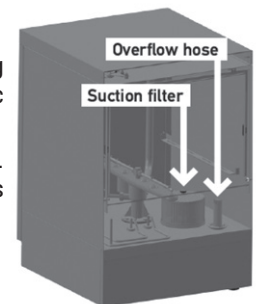

Filling of Detergent and Rinse Aid

This machine is equipped with peristaltic pumps for the rinse aid and the detergent filling. The filling inlets for each one are the two corresponding hoses which should be immersed in the appropriate tanks.

The filling procedure is performed in two stages. The initial filling (when you turn the machine on) and additional re-fillings after each washing cycle:

1st Stage: During automatic preparation (before the first wash) the machine receives from the tank soap for 180 sec and rinse aid for 35 sec. This could be adjusted from the user through the User Menu *Check Section "User Menu".

2nd Stage: During every complete washing & rinsing cycle, the machine receives detergent for 13 sec and rinse aid for 12 sec. This could be adjusted from the user through the User Menu *Check Section "User Menu"

NOTE: In case that you need to adjust the Detergent or Rinse Aid from the User Menu, please bear in mind that for each second the corresponding pump captures the following liquid quantities:

Detergent pump: 0.83 ml/sec

Rinse Aid pump: 0.19 ml/sec

By multiplying these quantities with the time duration (seconds) that the pump works, you can calculate the volume of each liquid that it is used.

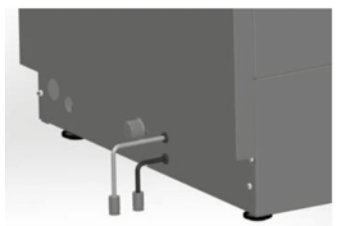



Warning: The machine receives rinse aid during washing cycle and detergent during rinsing cycle.

Cold Water Rinse

This machine has Cold Water Rinse operation. It could be activated in order to be performed after every washing cycle or for On Demand occasions. In order to perform a Cold Water Rinse after one washing cycle, press Button SW5 for 1 sec. A single sound buzz will inform you that the machine is set up for a single cold rinse performance. Then, LED L5 will be on, while the procedure is performed.

In case that you wish to perform Cold Water Rinse after each washing cycle, press hold Button SW5 for 5 sec while the machine is on Standby mode. A double sound buzz will inform you that the machine is set up for a cold rinse performance after every washing cycle (LED L5 will lit). Should you undo the selection, please repeat the above procedure.

Shutting down the machine

In case that you want to shut down the machine, remove the overflow hose in the wash tank and press the Button SW4. The machine is going to drain automatically the used water, perform a self-cleaning cycle and then shut down. An alternative way is to press continuously the Button SW6 until the indication "OFF" appears in the first line of the screen (it will take about 5 sec). The recommended way is the first.

ECO Function

In case that the machine is in Standby operation for more than 15 minutes, the Boiler's temperature lowers in order to avoid unnecessary power consumption. During these intervals, if the door of the washing machine opens, the ECO Function stops.*

Soft Start Function

This machine is equipped with Soft Start System that enables the water pump to start with lower pressure and gradually increases it, so that the sensitive crystals are not damaged.

User's Menu

In order to enter the User's Menu, shut down the machine and press hold Buttons SW1, SW3 & SW6 at the same time for 3 sec with the door closed. LED L6 flashes and a beeper sounds three times. Message "conf" appears for a few seconds and the User's Menu is activated.

Find the parameter that you wish to adjust using Buttons SW3 and SW4 for navigation inside the menu. The corresponding parameter will be displayed on the screen.

Should you wish to increase the amount (+), press Button SW1

Should you wish to decrease the amount (-), press Button SW2

After defining the value, press Button SW5 once in order to register the value in the memory.

In the matrix that is presented below you can find a short description of the functions that can be adjusted by the user, as well as their default value.

N°	Parameter	Range	Default	Indication
1	TEMPERATURE MODE	C/F	C	C
2	BOILER TEMPERATURE	30-92 C	85 C	bt
3	TANK TEMPERATURE	30-70 C	60 C	tt
4	DETERGENT TIME AT FILLING	100 – 300 SEC	180 SEC	dF
5	DETERGENT TIME AT CYCLE	0 – 30 SEC	13 SEC	dc
6	RINSE AID TIME AT FILLING	0 – 90 SEC	35 SEC	rF
7	RINSE AID TIME AT CYCLE	0 – 30 SEC	12 SEC	rC
8	COLD RINSE	0 (NON) – 1(OUI)	1	Cr
9	DRAINING DURATION	20 -60 SEC	25	Cd

In order to exit the User's Menu, press-hold Button SW6 for 3 sec. The beeper sounds three times and message "off" appears on the screen.

After closing the User's Menu, the machine is shut down.

Maintenance and Repair

After 50.000 washing cycles, a Service reminding message will be displayed in the screen. Regular maintenance, performed by licensed technician using original spare parts is essential for proper function of the machine.

Alarm Indications

If the system records any malfunction, then a warning message will be displayed on the screen. If such a condition occurs, please advise the following table which describes the problem shortly. Should you need further assistance, don't hesitate to contact your local reseller.

ALARM	PROBLEM DESCRIPTION
Alarm 1	Water filling time excession
Alarm 2	The water level during draining is not reduced
Alarm 3	Excess time of boiler heating
Alarm 4	Excess time of tank heating
Alarm 5	Water temperature in the boiler is above limits
Alarm 6	Water temperature in the wash tank is above limits
Alarm 7	Cold rinse alarm

TROUBLESHOOTING

PROBLEM	CAUSE	REMEDY
The dishwasher does not operate properly	Connection interruption	Check the connection
	You have not turned the switch of the appliance ON	Turn the switch ON
	Main switch / or fuse has not been activated / or it is faulty	Check the main switch / or fuse
	The switch of the appliance is faulty	Refer to the authorized local dealer who sold the appliance or directly to the manufacturer
	The water inlet valve is faulty	
	The door is not closed	Close the door
	You have not turned the water supply on	Turn the supply on
The appliance operates, but the switch LED does not light on	The LED is faulty	Change the LED
Boiler heating does not operate	Switch or main switch or fuse has not been activated	Check the switch of the appliance and the main switch or fuse
	The safety thermostat of the boiler is faulty	Refer to the authorized local dealer or the manufacturer
	The 93 thermal fuse of the boiler is faulty	
	Pressure regulator is faulty	Refer to the authorized local dealer or the manufacturer
	"Boiler heating" relay is faulty	
Boiler fuse is burned out	Refer to the authorized local dealer or the manufacturer	
Boiler heating operates, but LED does not turn on	Faulty LED	Change LED
Dispenser heating does not operate	Switch N1 of the appliance or main switch or fuse has not been activated	Activate the corresponding switch or fuse
	Boiler heating is open	Wait
The 85°C thermal fuse is faulty. The dispenser's fuse is burned out	The thermostat switch of 60 heating is faulty	Refer to the authorized local dealer or the manufacturer
	"Compartment heating" relay is faulty	
Dispenser's heating operates, but LED does not turn on	Faulty LED	Change LED
Pump motor does not operate	Main switch or fuse is not activated. The door is not closed.	Activate the main switch or fuse Close the door
	Main relay is faulty	Refer to the authorized local dealer or the manufacturer
	Pump motor is faulty	
	Program selection switch is faulty	
Motor operates, but pump does not rotate	An object has jammed the pump fin	Refer to the authorized local dealer or the manufacturer
	Salts or detergent have been petrified following non-operation of the appliance	Rotate the screw on the backside of the motor, until it rotates freely
Items do not dry (dishes, glasses, etc.)	Compartment has no drying aid	Insert drying aid to the compartment
	Drying valve is faulty	Refer to the authorized local dealer or the manufacturer
	Program switch is faulty	
	Rinsing arms do not rotate	
	Basket does not rotate	

ELECTRICAL DIAGRAM

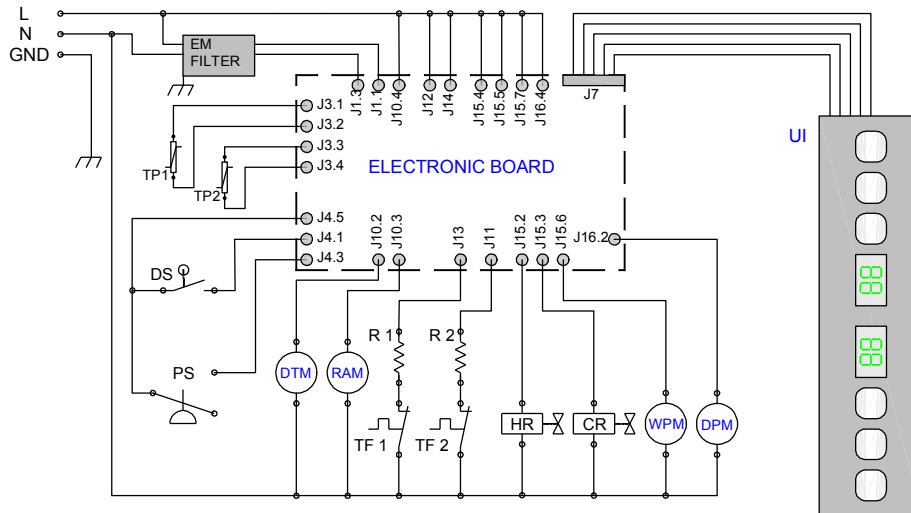

ELECTRICAL DIAGRAM
D-LV50-A3P
SIMPLE PRESSURE

220-240 Volt AC 50/60 Hz

- | | |
|------------------------------|---------------------------------|
| EMF : Electromagnetic filter | TF 1 : Boiler's Thermofuse |
| UI : Users interface | TF 2 : Tank's Thermofuse |
| DS : Door switch | CRV : Cold rinse valve |
| PS : Tank pressostat | HRV : Hot rinse valve |
| TP 1 : Boiler's thermo probe | RPM : Rinse pump motor |
| TP 2 : Tank's thermo probe | WPM : Wash pump motor |
| DTM : Detergent pump motor | DPM : Drain pump motor |
| RAM : Rinse aid pump motor | R 1 : Booster's heating element |
| | R 2 : Tank's heating element |

EXPLODED VIEW AND SPARE PARTS LIST

ITEM NO.	PART NUMBER	DESCRIPTION	QTY.
1	001.00.00213	INOX SCREW M4X15	2
2	002.00.00095	INOX NUT M4	2
3	002.00.00140	LOCK WASHER INOX Ø4	2
4	001.00.00043	BACK COVER INOX V50 - K50	1
5	001.00.00241	INOX SCREW M4X30	2
6	001.00.00048	FRONT COVER INOX V50	1
7	001.00.00015	UPPER COVER INOX V50 - K50	1

ITEM NO.	PART NUMBER	DESCRIPTION	QTY.
8	001.00.00011	BACK PART OF THE DOOR V-K	1
9	001.00.00027	FRONT PART OF THE DOOR V-K	1
10	001.00.00046	DOOR RIGHT SUPPORT AXLE MAX300	1
11	001.00.00048-M	DOOR LEFT SUPPORT AXLE MAX300	1
12	001.00.00021	PLASTIC GUIDE FOR DOOR AXLE	2
13	001.00.00073	INOX SCREW 2 X 10	4
14	001.00.00110	DOMED CAP NUT M4	2
15	001.00.00042	INOX TAPPED SCREW M5X16	2

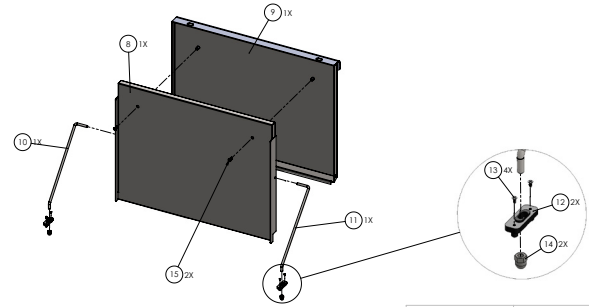
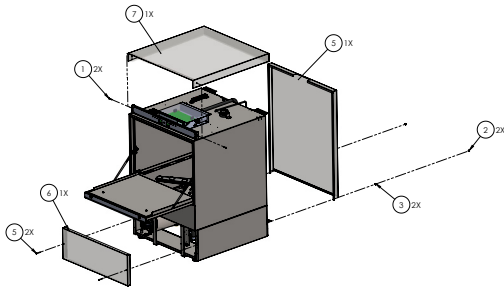

SERIES DESCRIPTION:		MODEL DESCRIPTION:		MODEL VERSION:		ITEM CODE:		ITEM DESCRIPTION:	
DISHWASHER		D-LV50-A3P		220-240V 1-N 50/60 Hz		004.50.00023		PAGE: 01 REVISION: 01	
DISHWASHER		D-LV50-A3P		220-240V 1-N 50/60 Hz		001.50.00046		ITEM DESCRIPTION: DOOR COMPLETE 500	
						004.50.00023		PAGE: 02 REVISION: 01	

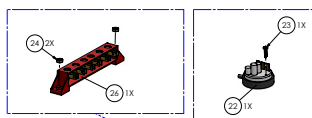

ITEM NO.	PART NUMBER	DESCRIPTION	QTY.
16	003.00.00086	SPACER FOR DOOR SWITCH	2
17	003.00.00041	NUT M6 GALVANNEED	2
18	003.00.00074	DOOR SWITCH ELECTRICAL PART COMPLETE	1
19	003.00.00045	GALV. HEX. BOLT M5X16	2
20	002.00.00090	GALV. NUT M3	2
21	003.00.00015	DOOR MICROSWITCH 16A	1
22	003.00.00033	PRESSOR(A)	1
23	002.00.00007	TAPPING SCREW 4.2 X 19	1
24	003.00.00046	NUT M4 (GALV)	2
25	001.00.00004	GALVANNEED LOCK WASHER 4x11x0.7	2
26	003.00.00030	POWER SUPPLY BOARD 6CON	1

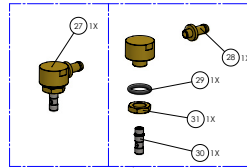

ITEM NO.	PART NUMBER	DESCRIPTION	QTY.
27	002.00.00009	UPPER RINSING BASE COMPLETE	1
28	002.00.00001	FITTINGS 1/4X10	1
29	002.00.00097	O-RING 20X4	1
30	002.00.00012	INOX AXLE RINSE BASE BL VE,IN1	1
31	002.00.00043	NUT Ø16	1
32	003.00.00007	CONTROL PANEL COMPLETE A500	1
33	003.00.00036	BOARD PANEL COMPLETE A500	1
34	001.00.00045	TERFON WASHER Ø12.5 X 8 X 2.5	2
35	003.00.00016	WASHER STEEL 6x8x18	2
36	001.00.00004	GALVANNEED LOCK WASHER 4x11x0.7	2
37	003.00.00041	NUT M6 GALVANNEED	2

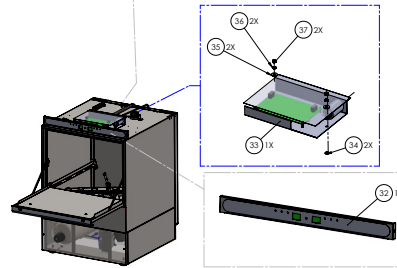
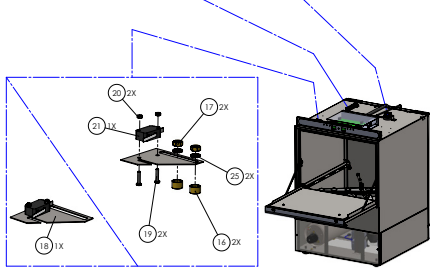

SERIES DESCRIPTION:		MODEL DESCRIPTION:		MODEL VERSION:		ITEM CODE:		ITEM DESCRIPTION:	
DISHWASHER		D-LV50-A3P		220-240V 1-N 50/60 Hz		004.50.00023		PAGE: 03 REVISION: 01	
DISHWASHER		D-LV50-A3P		220-240V 1-N 50/60 Hz		004.50.00023		PAGE: 04 REVISION: 01	

ITEM NO.	PART NUMBER	DESCRIPTION	QTY.
38	001.00.00044	SWITCH PANEL INOX V50	1
39	003.00.00009	USER INTERFACE 7 SEG. DISPLAY VERSION	1
40	003.00.00026	FILM FOR A500 (LCD)	1
41	002.00.00090	GALV. NUT M3	4

ITEM NO.	PART NUMBER	DESCRIPTION	QTY.
42	001.00.00083	BOARD BASE INOX A500	1
43	003.00.00625	ELECTROMAGNETIC FILTER 250W 50/60HZ 10A 85°C	1
44	003.00.00630	SPACER PCB KC-12 PLASTIC	4
45	003.00.00607	ATLAS MAIN BOARD VERSION 1	1
46	003.00.00037	COVER PP FOR PANEL A500	1
47	003.00.00610-1	ATLAS CONNECTION CABLE 500mm	1

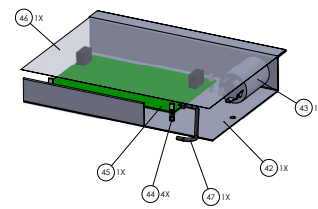
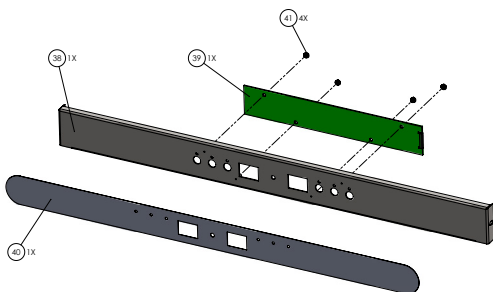

SERIES DESCRIPTION:		MODEL DESCRIPTION:		MODEL VERSION:		ITEM CODE:		ITEM DESCRIPTION:	
DISHWASHER		D-LV50-A3P		220-240V 1-N 50/60 Hz		004.50.00023		PAGE: 05 REVISION: 01	
DISHWASHER		D-LV50-A3P		220-240V 1-N 50/60 Hz		003.00.00027		ITEM DESCRIPTION: CONTROL PANEL COMPLETE A500	
						004.50.00023		PAGE: 06 REVISION: 01	

INSTRUCTION MANUAL : D-LV50-A3P

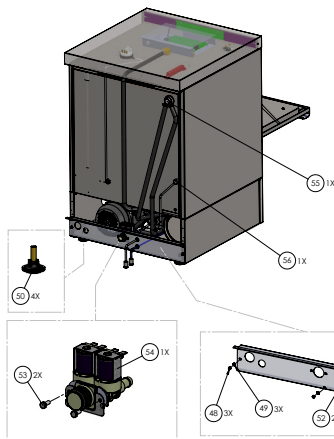

ITEM NO.	PART NUMBER	DESCRIPTION	QTY.
46	002.00.00095	INOX NUT M4	3
47	002.00.00140	LOCK WASHER INOX Ø4	3
50	001.00.00016	SMALL BLACK FOOD M10	4
51	001.50.00072	INOX LOWER BACK COVER V500	1
52	003.00.00025	CABLE RUBBER PROTECTOR	2
53	003.00.00278	GALV. BOLT M4X10	2
54	003.00.00151	WATER PUMP VALVE DOUBLE	1
55	003.00.00269	NON RETURN VALVE (DNVGW)	1
56	002.00.00233	DETERGENT TANK INJECTOR	1

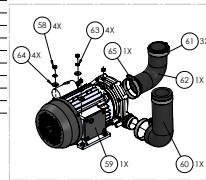

ITEM NO.	PART NUMBER	DESCRIPTION	QTY.
57	006.50.00001	BOILER COMPLETE WITH HEATER ELEM. V500	1
58	003.00.00041	NUT M6 GALVANISED	5
59	003.00.00050	PUMP Ø 75x6 50Hz 230V IP44	1
60	002.50.00033	WASH PUMP HOSE (OUTLET)	1
61	002.00.00050	CLAMP 40-60	3
62	002.00.00127-1	WASH PUMP HOSE (INPUT)	1
63	001.00.00024	GALVANISED LOCK WASHER 4x11.5x7	5
64	003.00.00016	WASHER STEEL Ø4x18	5
65	002.00.00049	CLAMP 35-50	1

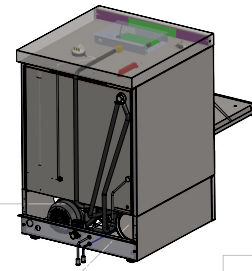
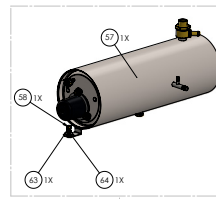

SERIES DESCRIPTION:	MODEL DESCRIPTION:	MODEL VERSION:	MODEL CODE:	PAGE:	REVISION:	SERIES DESCRIPTION:	MODEL DESCRIPTION:	MODEL VERSION:	MODEL CODE:	PAGE:	REVISION:
DISHWASHER	D-LV50-A3P	220-240V 1-N 50/60 Hz	004.50.00023	07	01	DISHWASHER	D-LV50-A3P	220-240V 1-N 50/60 Hz	004.50.00023	08	01

ITEM NO.	PART NUMBER	DESCRIPTION	QTY.
66	001.50.00017	BOILER V500 Ø140x400	1
67	002.50.00001	OUTLET BASE BOILER V500	1
68	002.00.00001	FITTINGS 1/4X10	1
69	002.00.00097	Ø RING 20x4	1
70	002.50.00016	BOILER DRAIN THERMOUSE CAP	1
71	003.00.00060	BOILER ELEMENT FITTINGS BASE	1
72	003.50.00005	HEATER ELEM. BOILER 3KW / 230V / 1/2"	1
73	003.00.00016	WASHER STEEL Ø4x18	3
74	003.00.00041	NUT M6 GALVANISED	3
75	003.00.00180	BOILER THERMOUSE 1050c	1
76	002.50.00090	GALV. NUT M3	3
77	001.00.00004	GALVANISED LOCK WASHER 4x11.5x7	3
78	003.00.00004	HEATER ELEMENT COVER	1
79	002.00.00150	CERAMIC BRACKETS	1
80	002.00.00062	NUT 1/2"	1

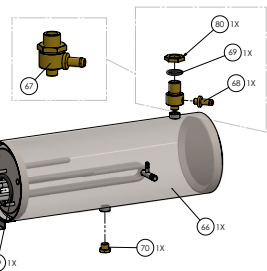

ITEM NO.	PART NUMBER	DESCRIPTION	QTY.
81	003.00.00168	THERMOUSE TANK POC	1
82	002.00.00090	GALV. NUT M3	2
83	001.50.00065	INOX BASE FOR DRAINING PUMP V500	1
84	002.00.00140	LOCK WASHER INOX Ø4	8
85	003.00.00046	NUT M4 (GALV)	4
86	003.00.00184	TANK DRAINING PUMP 230V / 45W	1
87	002.50.00014	DRAINING PUMP INLET PIPE V500	1
88	002.00.00048	CLAMP 25-40	2
89	003.00.00485	M6 GALVANISED BOLT	2
90	001.50.00078	BRACKET FOR TWO PERISTALTIC PUMPS V500	1
91	003.00.00433	PERISTALTIC RING PUMP G302 / 25x7	1
92	003.00.00429	PERISTALTIC DETERGENT PUMP G300 / 25x7	1
93	002.00.00095	INOX NUT M4	4

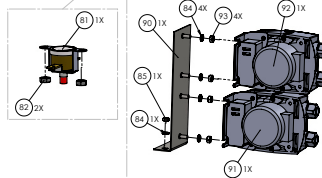
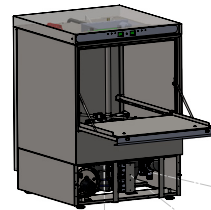

SERIES DESCRIPTION:	MODEL DESCRIPTION:	MODEL VERSION:	MODEL CODE:	PAGE:	REVISION:	SERIES DESCRIPTION:	MODEL DESCRIPTION:	MODEL VERSION:	MODEL CODE:	PAGE:	REVISION:
DISHWASHER	D-LV50-A3P	220-240V 1-N 50/60 Hz	004.50.00023	09	01	DISHWASHER	D-LV50-A3P	220-240V 1-N 50/60 Hz	004.50.00023	10	01

ITEM NO.	PART NUMBER	DESCRIPTION	QTY.	ITEM NO.	PART NUMBER	DESCRIPTION	QTY.
94	002.50.00026	RINSING ARM UP OR DOWN V.K	1	104	002.50.00005 (B)	RINSING ARM SINGLE - B	1
95	002.50.00004	LOCK NUT FOR RINSING ARM	1	105	002.50.00005 (A)	RINSING ARM - A	1
96	002.50.00018	WASHING UPPER SYSTEM INOX SUPPLY PIPE	1	106	002.00.00230	TEFLON Ø18x6	2
97	002.50.00017	CONNECTOR WASHING SYSTEM PLASTIC	1	107	002.11.00008	SPRAYER FOR RINSING ARM BLEU VE 2X 1.500	4
98	002.50.00020	WASHING UPPER SYSTEM INOX UP-RIGHT	1	108	002.00.00277	CAP FOR RISE ARMS	2
99	002.50.00030	SPRAYER FOR UPPER WASH ARMS	4	109	001.00.00073	INOX SCREW 2 x 10	2
100	002.00.00095	INOX NUT M4	1	110	002.50.00025	PLASTIC BASE FOR RINSING ARMS	1
101	002.50.00019	WASHING UPPER SYSTEM INOX UP-LEFT	1				
102	002.50.00030	SPRAYER FOR UPPER WASH ARMS	4				
103	002.00.00095	INOX NUT M4	1				

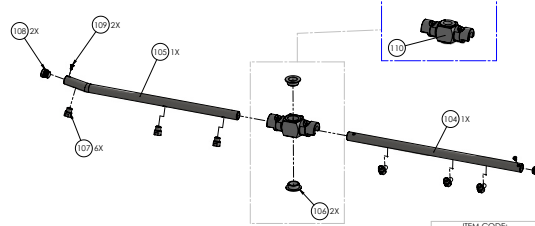
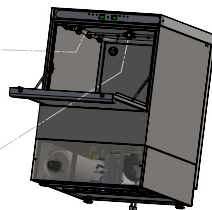
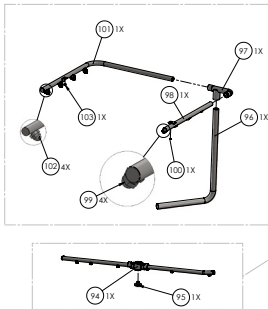

SERIES DESCRIPTION:	MODEL DESCRIPTION:	MODEL VERSION:	MODEL CODE:	PAGE:	REVISION:	SERIES DESCRIPTION:	MODEL DESCRIPTION:	MODEL VERSION:	MODEL CODE:	PAGE:	REVISION:
DISHWASHER	D-LV50-A3P	220-240V 1-N 50/60 Hz	004.50.00023	11	01	DISHWASHER	D-LV50-A3P	220-240V 1-N 50/60 Hz	004.50.00023	12	01

INSTRUCTION MANUAL : D-LV50-A3P



ITEM NO.	PART NUMBER	DESCRIPTION	QTY.
111	001.00.00051	DOOR SNAP SET	2
112	003.00.00221	DOOR SWITCH MECH. PART	1
113	003.00.00489	RUBBER GASKET 14X30.3	1
114	003.00.00071	NUT FOR DOOR SWITCH	1

ITEM NO.	PART NUMBER	DESCRIPTION	QTY.
115	003.00.00008	HEATER ELEMENT TANK 2.8 KW / 230V	1
116	002.00.00100	O-RING 14X3.5	2
117	003.00.00074	NUT 14 (GALV)	2
118	003.00.00014	PRESSOSTAT CHAMBER	1
119	002.00.00087	NUT M10	1
120	002.00.00091	O-RING 3X10.5	1

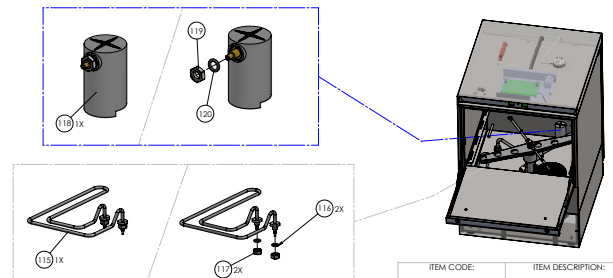
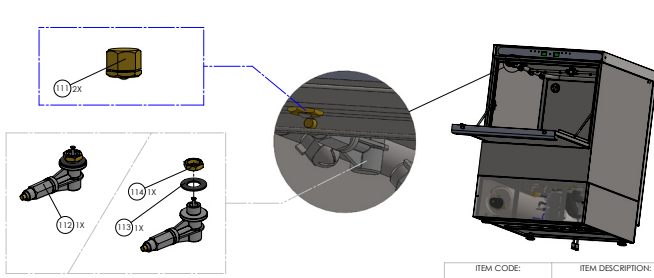

SERIES DESCRIPTION:	MODEL DESCRIPTION:	MODEL VERSION:	MODEL CODE:	PAGE:	REVISION:	SERIES DESCRIPTION:	MODEL DESCRIPTION:	MODEL VERSION:	MODEL CODE:	PAGE:	REVISION:
DISHWASHER	D-LV50-A3P	220-240V 1-N 50/60 Hz	004.50.00023	13	01	DISHWASHER	D-LV50-A3P	220-240V 1-N 50/60 Hz	004.50.00023	14	01

SERIES DESCRIPTION:	MODEL DESCRIPTION:	MODEL VERSION:	MODEL CODE:	PAGE:	REVISION:	SERIES DESCRIPTION:	MODEL DESCRIPTION:	MODEL VERSION:	MODEL CODE:	PAGE:	REVISION:
DISHWASHER	D-LV50-A3P	220-240V 1-N 50/60 Hz	004.50.00023	14	01	DISHWASHER	D-LV50-A3P	220-240V 1-N 50/60 Hz	004.50.00023	14	01

ITEM NO.	PART NUMBER	DESCRIPTION	QTY.
121	001.00.00040	DRAIN PUMP FILTER V500	1
122	001.00.00000	FILTER IN THE TANK FOR THE PUMP V. 50	1
123	001.00.00017	FILTER RETAINING NUT	1
124	002.00.00081	PLASTIC BASE FOR TANK FILTER V.K.	1
125	002.00.00093	O-RING 52X2.5	1
126	002.00.00037	NUT 1 1/2"	1
127	002.00.00057	DRAIN & OVERFLOW VALVE PLASTIC BASE	1
128	002.00.00230	RUBBER GASKET 33X30X1	1
129	002.00.00133	BROUZE NUT M36	1
130	002.00.00037	DRAIN AND OVERFLOW VALVE PLASTIC PART NEW V.K.	1

ITEM NO.	PART NUMBER	DESCRIPTION	QTY.
131	002.00.00004	LOCK NUT FOR BRUSHING ARM	1
132	002.00.00105	RUBBER GASKET 103X58X3	1
133	003.00.00041	NUT M6 GALVANNEED	4
134	002.11.00002	AXLE INOX FOR BASE DOWN V500	1
135	002.00.00002	RINSE PIPE INOX V.K.	1
136	002.00.00144	RINSE PIPE RETAINING NUT	2
137	001.00.00004	GALVANNEED TUBO WASHER 6x11.6	4
138	003.00.00106	INOX HEX BOLT M4X15	1
139	002.00.00024	ADAPTOR Ø40-25 FOR WASH BASE	1
140	002.00.00229	TEFLON Ø23X10	2
141	003.00.00016	FLOW CONTROLLER FOR BASE V.K.	1
142	003.00.00016	WASHER STEEL Ø4x18	4
143	003.00.00104	INOX HEX BOLT M4X20	4
144	002.00.00169	TEFLON 12-6-2	4
145	002.00.00071	O-RING 20X4	1
146	002.00.00091	O-RING 3X10.5	1

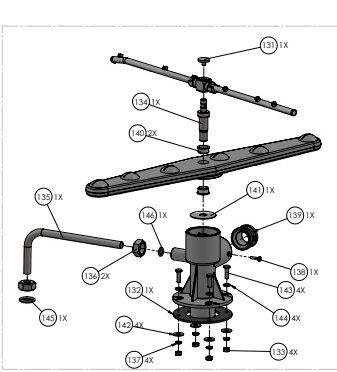
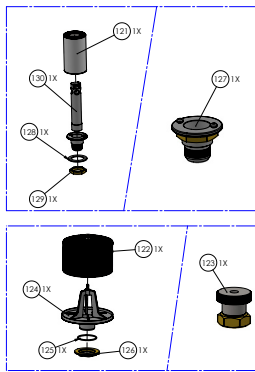

SERIES DESCRIPTION:	MODEL DESCRIPTION:	MODEL VERSION:	MODEL CODE:	PAGE:	REVISION:	SERIES DESCRIPTION:	MODEL DESCRIPTION:	MODEL VERSION:	MODEL CODE:	PAGE:	REVISION:
DISHWASHER	D-LV50-A3P	220-240V 1-N 50/60 Hz	004.50.00023	15	01	DISHWASHER	D-LV50-A3P	220-240V 1-N 50/60 Hz	004.50.00023	16	01

SERIES DESCRIPTION:	MODEL DESCRIPTION:	MODEL VERSION:	MODEL CODE:	PAGE:	REVISION:	SERIES DESCRIPTION:	MODEL DESCRIPTION:	MODEL VERSION:	MODEL CODE:	PAGE:	REVISION:
DISHWASHER	D-LV50-A3P	220-240V 1-N 50/60 Hz	004.50.00023	16	01	DISHWASHER	D-LV50-A3P	220-240V 1-N 50/60 Hz	004.50.00023	16	01

ITEM NO.	PART NUMBER	DESCRIPTION	QTY.
147	002.00.00026	RINSE ARM UP OR DOWN V.K.	1
148	002.00.00036	WASHING BASE DOWN V.K COMPLETE	1
149	002.00.00056	LOWER WASHING ARM V50	1

ITEM NO.	PART NUMBER	DESCRIPTION	QTY.
150	002.00.00002	NON RETURN VALVE FOR RINSE AID TUBES	1
151	002.00.00119-14	WASHING MACHINE HOSE BLACK 15X15	1
152	002.00.00119-12	WASHING MACHINE HOSE BLACK 12X15	1
153	002.00.00119-15	WASHING MACHINE HOSE BLACK 15X15	1
154	003.00.00487-4	TUBE PVC BLUE 4x6	1
155	003.00.00140-9	TUBO CRISTALLO 4x6	1
156	003.00.00140-8	TUBO CRISTALLO 4x6	1
157	003.00.00487-5	TUBE PVC BLUE 4x6	1
158	002.00.00195	BALANCE F15000	2
159	002.00.00242	FILTER PLASTIC FOR RINSE AID VALVE 2	2
160	003.00.00140-10	TUBO CRISTALLO 4x6	1
161	002.00.00052	CLAMP 15-16	10
162	002.00.00087	FITTINGS 1/8"	1
163	002.00.00130-2	WASHING MACHINE HOSE BLACK 14X12	1
164	002.00.00231	CLAMP 8-12	2
165	002.01.00007	T-CONNECTION BOILER KNOSSOS	1
166	002.00.00119-16	WASHING MACHINE HOSE BLACK 16X15	1
167	002.00.00119-17	WASHING MACHINE HOSE BLACK 16X15	1

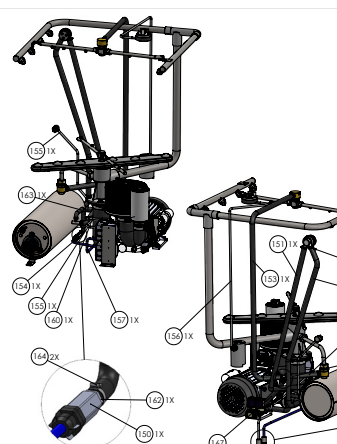
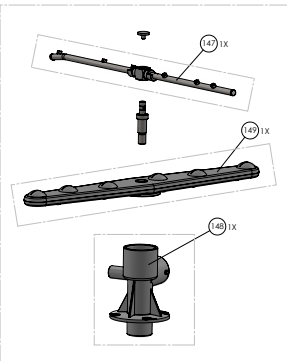

SERIES DESCRIPTION:	MODEL DESCRIPTION:	MODEL VERSION:	MODEL CODE:	PAGE:	REVISION:	SERIES DESCRIPTION:	MODEL DESCRIPTION:	MODEL VERSION:	MODEL CODE:	PAGE:	REVISION:
DISHWASHER	D-LV50-A3P	220-240V 1-N 50/60 Hz	004.50.00023	17	01	DISHWASHER	D-LV50-A3P	220-240V 1-N 50/60 Hz	004.50.00023	18	01

SERIES DESCRIPTION:	MODEL DESCRIPTION:	MODEL VERSION:	MODEL CODE:	PAGE:	REVISION:	SERIES DESCRIPTION:	MODEL DESCRIPTION:	MODEL VERSION:	MODEL CODE:	PAGE:	REVISION:
DISHWASHER	D-LV50-A3P	220-240V 1-N 50/60 Hz	004.50.00023	18	01	DISHWASHER	D-LV50-A3P	220-240V 1-N 50/60 Hz	004.50.00023	18	01

STANDARDS AND DIRECTIVES

Meaning of crossed out wheeled dustbin:

Do not dispose of electrical appliances as unsorted municipal waste, use separate collection facilities.

Contact your local government for information regarding the collection systems available.

If electrical appliances are disposed of in landfills or dumps, hazardous substances can leak into the groundwater and get into the food chain, damaging your health and well-being.

When replacing old appliances with new ones, the retailer is legally obligated to take back your old appliance for disposals at least free of charge.

The device complies with current EU standards and directives. If necessary, we will send you the corresponding declaration of conformity.

Packaging disposal

Please separate the packaging materials accordingly and return them to the responsible collection points for recycling and environmental housing.



Device disposal

once the appliance has been used up, dispose of it properly at a collection point for electrical appliances. Electrical appliances do not belong in household waste.

Your responsible administration will inform you about the addresses and opening hours of collection points. This is the only way to ensure that old appliances are properly disposed of and recycled. Thank you very much!





CE